

## SCINTILLA MEDIUM

Piero e Livio Castiglioni, 1972

The absolutely novel Scintilla system combines the essential versatility of a decorative lamp and a lighting capacity comparable to a technical system. The great success of this system persuaded the company to design a free-standing version in the early eighties, with the main structure fastened to the base and stem in metal.

Wall lamp with diffused and dimmable light. Nickel-plated metal frame. The lamp is supplied with two different diffusers: one in clear borosilicate glass and the other in sandblasted borosilicate glass. E' possibile acquistare separatamente un anodized aluminum reflector that produces indirect light. Bulb not included.

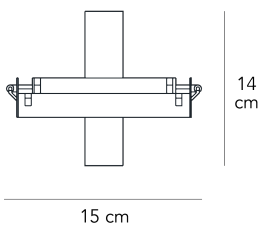

**MADE IN**  
IT

**DIMMER**  
Dimmable

**CERTIFICATIONS**  
**CE ENEC IP20**

**COLOR**

**MATERIAL DESCRIPTION**  
metal, glass

**COLOR DESCRIPTION SKU**  
satin nickel/brushed

**GROUP TENSION**  
Bulb

**ENERGY CLASS**  
A → G

**LIGHT SOURCE**  
HA 1x120W R7s/80 (2900K, 2250Lm)

**SKU**  
FP15045250NSNE



## SCINTILLA MEDIUM

Piero e Livio Castiglioni, 1972

The absolutely novel Scintilla system combines the essential versatility of a decorative lamp and a lighting capacity comparable to a technical system. The great success of this system persuaded the company to design a free-standing version in the early eighties, with the main structure fastened to the base and stem in metal.

Wall lamp with diffused and dimmable light. Chromed metal frame. The lamp is supplied with two different diffusers: one in clear borosilicate glass and the other in sandblasted borosilicate glass. Available separately a reflector made of anodized aluminum that produces indirect light. Bulb not included.

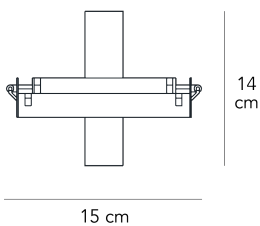

**MADE IN**  
IT

**DIMMER**  
Dimmable

**CERTIFICATIONS**  
CE ENEC IP20

**COLOR**  
● ●

**MATERIAL DESCRIPTION**  
metal, glass

**COLOR DESCRIPTION SKU**  
chrome

**GROUP TENSION**  
Bulb

**ENERGY CLASS**  
A → G

**LIGHT SOURCE**  
1x max 120W R7s/80

**SKU**  
FP15045250CRNE

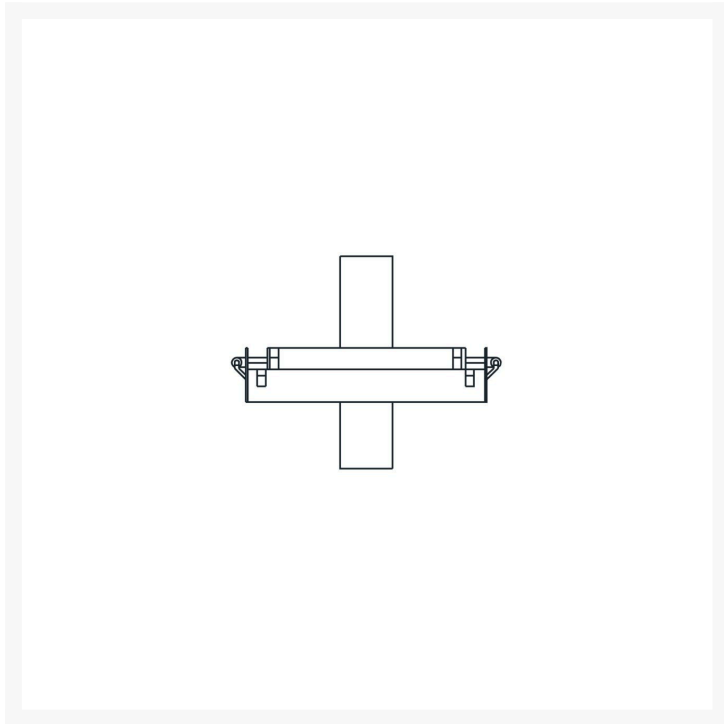

## SCINTILLA LARGE

Piero e Livio Castiglioni, 1972

The absolutely novel Scintilla system combines the essential versatility of a decorative lamp and a lighting capacity comparable to a technical system. The great success of this system persuaded the company to design a free-standing version in the early eighties, with the main structure fastened to the base and stem in metal.

Wall lamp with diffused and dimmable light. Nickel-plated metal frame. The lamp is supplied with two different diffusers: one in clear borosilicate glass and the other in sandblasted borosilicate glass. Available separately a reflector made of anodized aluminum reflector that produces indirect light. Bulb not included.

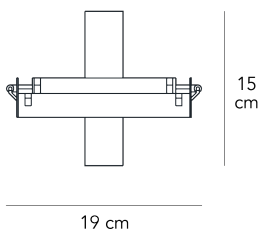

**MADE IN**  
IT

**DIMMER**  
Dimmable

**CERTIFICATIONS**  
CE ENEC IP20 

**COLOR**  

**MATERIAL DESCRIPTION**  
metal, glass

**COLOR DESCRIPTION SKU**  
satin nickel/brushed

**GROUP TENSION**  
Bulb

**ENERGY CLASS**  
A → G

**LIGHT SOURCE**  
1x max 230W R7s/115

**SKU**  
FP30050250NSNE



## SCINTILLA LARGE

Piero e Livio Castiglioni, 1972

The absolutely novel Scintilla system combines the essential versatility of a decorative lamp and a lighting capacity comparable to a technical system. The great success of this system persuaded the company to design a free-standing version in the early eighties, with the main structure fastened to the base and stem in metal.

Wall lamp with diffused and dimmable light. Chromed metal frame. The lamp is supplied with two different diffusers: one in clear borosilicate glass and the other in sandblasted borosilicate glass. Available separately a reflector made of anodized aluminum reflector that produces indirect light. Bulb not included.

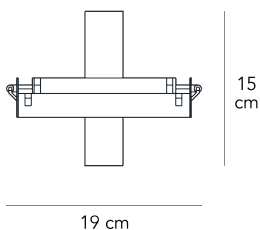

**MADE IN**  
IT

**DIMMER**  
Dimmable

**CERTIFICATIONS**  
CE ENEC IP20 

**COLOR**  

**MATERIAL DESCRIPTION**  
metal, glass

**COLOR DESCRIPTION SKU**  
chrome

**GROUP TENSION**  
Bulb

**ENERGY CLASS**  
A → G

**LIGHT SOURCE**  
1x max 230W R7s/115

**SKU**  
FP30050250CRNE